

**SOLBERG AVIATION COMPANY
READINGTON, NEW JERSEY**

**SOLBERG-HUNTERDON AIRPORT
AIRPORT LAYOUT PLAN**



D&Z TRANSPORTATION SERVICES
A DIVISION OF DAY & ZIMMERMANN INFRASTRUCTURE, INC.

INDEX TO SHEETS

1. COVER SHEET
2. EXISTING AIRPORT LAYOUT PLAN
3. PROPOSED AIRPORT LAYOUT PLAN
4. BUILDING AREA PLAN PHASE I
5. BUILDING AREA PLAN PHASE II
6. RUNWAY 4-22 APPROACH PLAN
AND CENTERLINE PROFILE
7. RUNWAY 10-28 APPROACH PLAN
AND CENTERLINE PROFILE
8. RUNWAY 13-31 EXISTING AND PROPOSED
APPROACH PLAN AND CENTERLINE PROFILE
9. PROPOSED RUNWAY 3-21 APPROACH PLAN
AND CENTERLINE PROFILE
10. EXISTING AIRPORT SURFACES - PART 77
11. PROPOSED AIRPORT SURFACES - PART 77
12. 2015 NOISE CONTOURS AND N.J. AIR SAFETY ZONE
13. EXHIBIT 'A' PROPERTY MAP

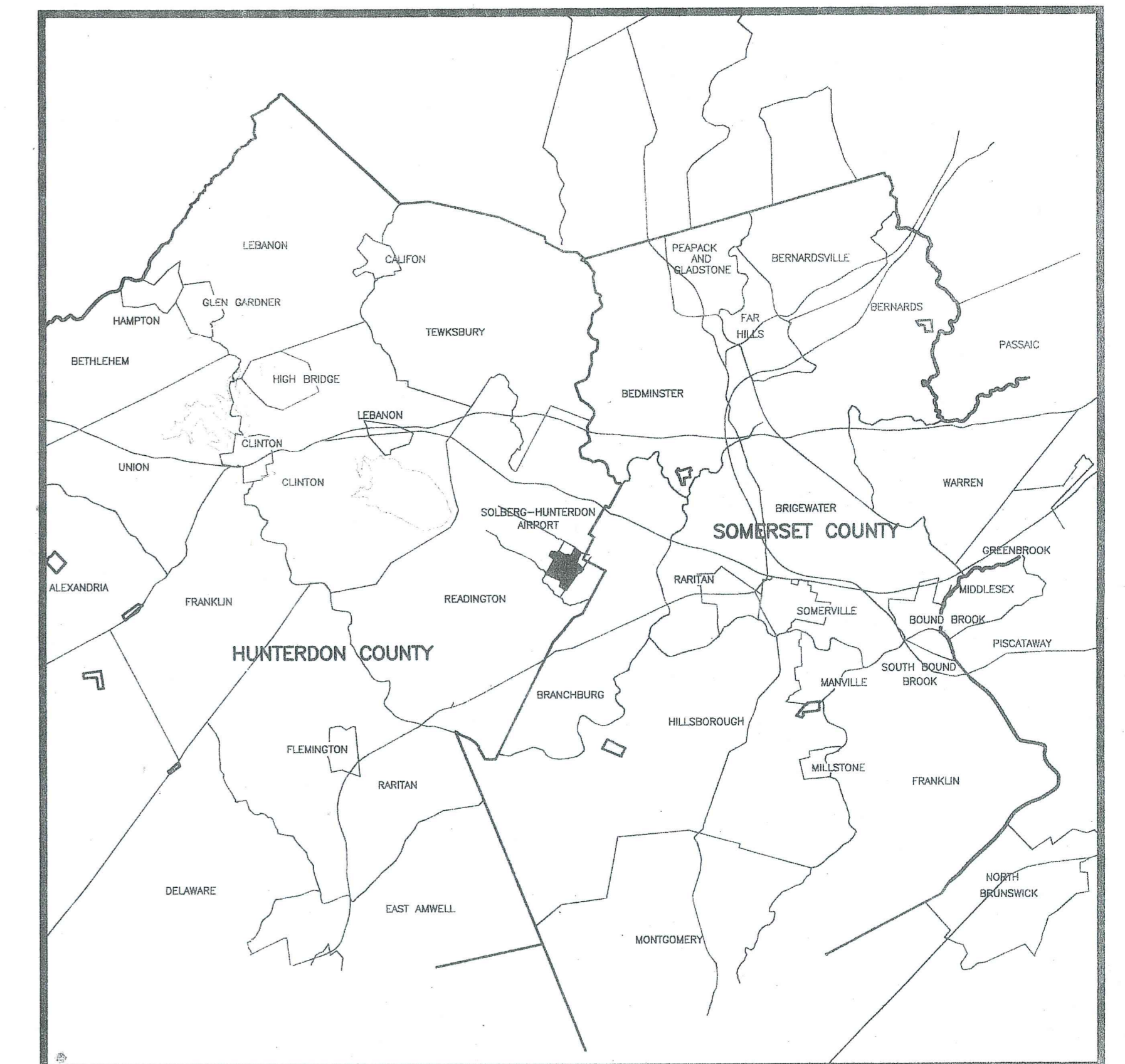

This drawing set was prepared in accordance with FAA guidelines and is not intended for use as a construction document. All future construction projects are contingent upon FAA review and approval.

This study was conducted with the financial assistance of a federal grant from the Federal Aviation Administration of the United States Department of Transportation, under the Airport Improvement Program authorized by the Airport and Airway Improvement Act of 1983 and amended by the Airport and Airway Safety and Capacity Expansion Act of 1987 (AP Project #3-34-0023-01-90). Additional financial assistance was provided by the New Jersey Department of Transportation, Division of Aeronautics (Grant 90-23).

FAA's approval of this Airport Layout Plan (ALP) represents acceptance of the general location of future facilities depicted. During the preliminary design phase the Airport owner is required to resubmit for approval final locations, heights and exterior finish of structures. FAA concern is construction, impact on electronic aids or adverse effect on controller view of aircraft approaches and ground movement areas, which could adversely affect the safety, efficiency or utility of the airport.

Courtesy airport-hunterdon.org

CRD 26.09.97-09:26 E:\ACAD\WORK\SQL\cover.dwg

AIRPORT DATA

ITEM	
AIRPORT REFERENCE POINT (NAD 83)	40°34'0.97"N 74°44'19"W
AIRPORT ELEVATION	195'
MEAN MAX TEMP.	86° F (JULY)
AIRPORT CLASSIFICATION	GENERAL AVIATION
AIRPORT ROLE	GENERAL UTILITY (GU)
AIRPORT REFERENCE CODE	B - I (SMALL ONLY)
AIRPORT ACREAGE	714.04 ac.
MAGNETIC VARIATION	11'
DESIGN AIRCRAFT	CHEYENNE III A
AIRPORT TERMINAL NAVAIDS	VORTAC, ROTATING BEACON

IFR WIND ROSE

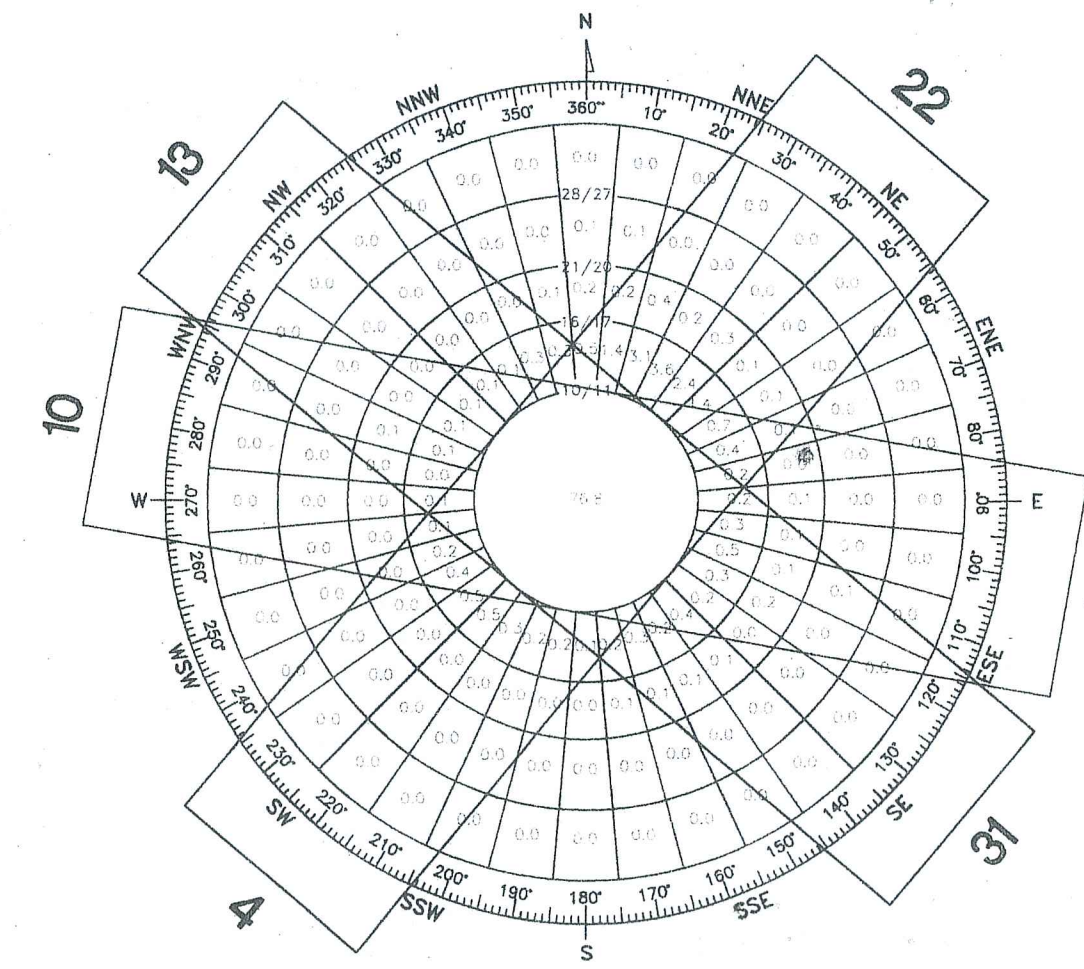

ALL WEATHER WIND ROSE

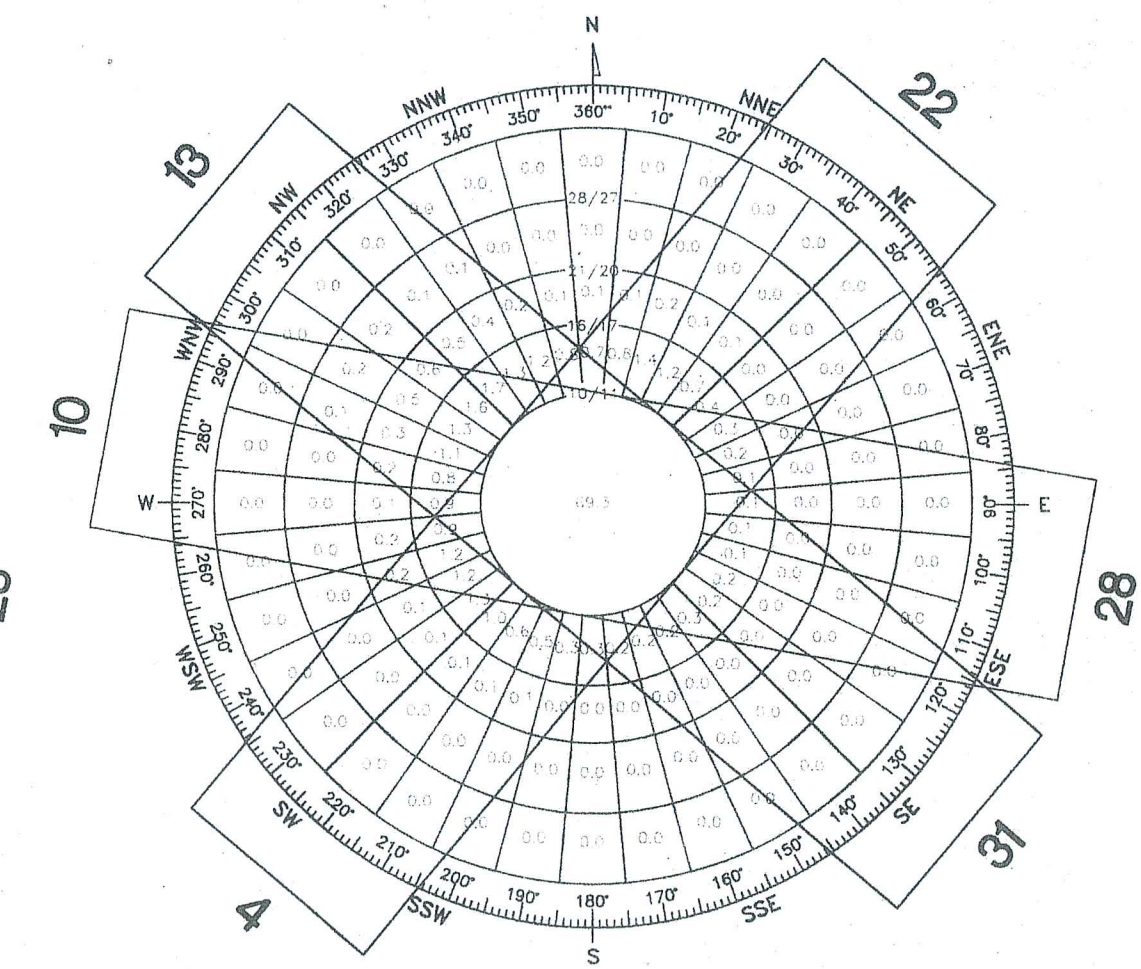

PERCENT WIND COVERAGE TABLE

CONDITION	RUNWAY HEADING					
	4	22	10	28	13	31
IFR	95.1%	79.7%	82.2%	79.3%	83.1%	79.4%
10.5 KNOTS	95.1%	84.4%	84.4%	83.1%	83.1%	83.1%

PERCENT WIND COVERAGE TABLE

CONDITION	RUNWAY HEADING					
	4	22	10	28	13	31
ALL WEATHER	76.4%	77.3%	71.5%	83.6%	71.4%	84.6%
10.5 KNOTS	85.0%	86.1%	86.1%	86.7%	86.7%	86.7%

RUNWAY DATA

ITEM	RUNWAY 4-22	RUNWAY 10-28	RUNWAY 13-31			
RUNWAY DIMENSIONS	3735' x 183' (3000' x 50' PAVED)	2456' x 160'	3440' x 200'			
TRUE BEARING	N 51°00'00" E	S 6°42'31" E	S 39°00'00" E			
EFFECTIVE GRADIENT	0.75%	1.12%	1.10%			
MAXIMUM ELEVATION	189.0'	187.5'				
AW WIND COVERAGE	85.0%	86.1%	86.7%			
IFR WIND COVERAGE	95.1%	84.4%	83.1%			
PAVEMENT TYPE	ASPHALT-TURF	TURF	TURF			
PAVEMENT STRENGTH	12,500 SW					
RUNWAY CATEGORY	NPI-UTILITY	VISUAL-UTILITY	VISUAL-UTILITY			
RUNWAY LIGHTING	MIRL	NONE	NONE			
RUNWAY MARKING	VISUAL	NONE	NONE			
RUNWAY SAFETY AREA	4215' x 120'	2936' x 120'	3750' x 120'			
RUNWAY PROT. ZONE	500' x 700' x 1,000'	250' x 450' x 1,000'	250' x 450' x 1,000'			
OBJECT FREE AREA	4335' x 250'	3056' x 250'	3800' x 250'			
	RW 4	RW 22	RW 10	RW 28	RW 13	RW 31
NAVIGATIONAL AIDS	VOR+GPS	VOR+GPS-A	VOR+GPS-A	VOR+GPS-A	VOR+GPS-A	VOR+GPS-A
VISUAL LIGHTING AIDS	MIRL	MIRL	NONE	NONE	NONE	NONE
APPROACH SLOPE	20:1	20:1	20:1	20:1	20:1	20:1
RUNWAY END COORDINATES						
LATITUDE (NAD 83)	40°34'38" N	40°35'2" N	40°35'4" N	40°34'56" N	40°35'23" N	40°34'59" N
LONGITUDE (NAD 83)	74°44'37" W	74°44'0" W	74°44'32" W	74°44'2" W	74°44'20" W	74°43'55" W
ELEVATION (MSL)	189.0'	160.2'	187.5'	159.0'	186.9'	152.4'
TAXIWAY WIDTH	25'					
WEATHER STATION	NEWARK INT'L AIRPORT, NEWARK, NJ					
SOURCE	NATIONAL CLIMATIC DATA CENTER, ASHEVILLE, N.C.					
PERIOD	1981-1990					
TOTAL AW WIND COVERAGE	99.3%					
TOTAL IFR WIND COVERAGE	99.3%					

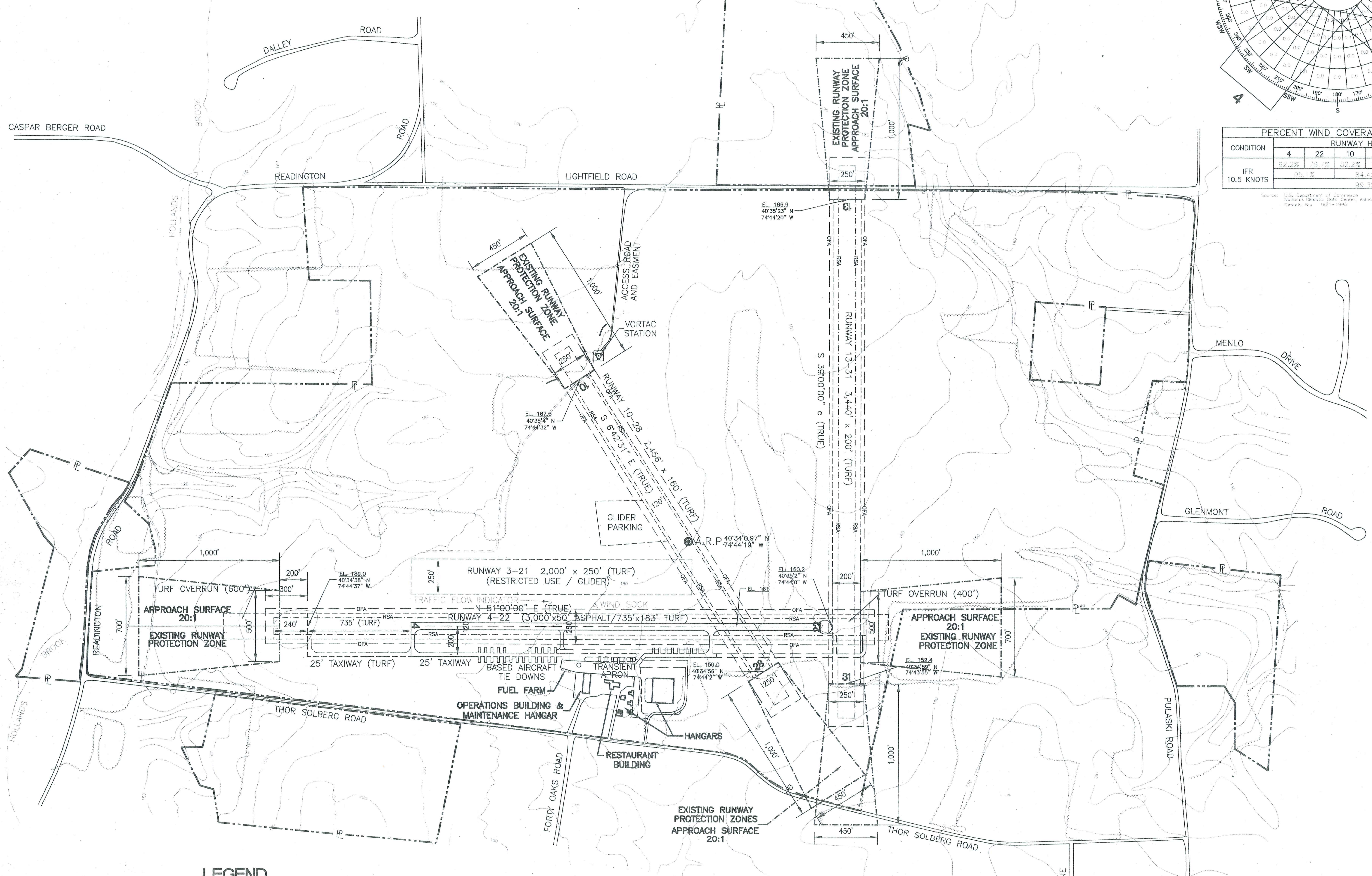

LEGEND

	PROPERTY LINE
	RUNWAY SAFETY AREA
	OBJECT FREE AREA
	RUNWAY PROTECTION ZONE
	EXISTING BUILDING
	CONTOUR LINE (10')
	TREE LINE

MODIFICATIONS TO STANDARDS

ITEM	STANDARD	MODIFICATIONS	REMARKS	APPROVED

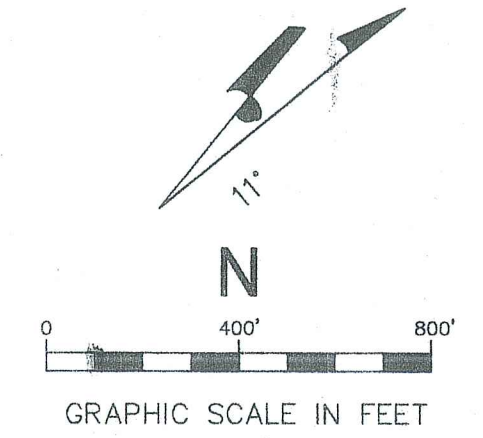

This drawing set was prepared in accordance with FAA guidelines and is not intended for use as a construction document. All future construction projects are contingent upon FAA review and approval.

This study was conducted with the financial assistance of a federal grant from the Federal Aviation Administration of the United States Department of Transportation, under the Airport Improvement Program authorized by the Airport and Airway Safety and Capacity Expansion Act of 1987 (AIP Project #3-34-0033-01-90). Additional financial assistance was provided by the New Jersey Department of Transportation, Division of Aeronautics (Grant 90-23).

FAA's approval of this Airport Layout Plan (ALP) represents acceptance of the general location of future facilities depicted. During the preliminary design phase the Airport owner is required to resubmit for approval final locations, heights and exterior finish of structures. FAA concern is obstructions impact on electronic aids or adverse effect on controller view of aircraft approaches and ground movement areas, which could adversely affect the safety, efficiency or utility of the airport.

NO.	REVISION	DATE

Solberg-Hunterdon Airport Readington, NJ

EXISTING AIRPORT LAYOUT PLAN

DAY & ZIMMERMANN INFRASTRUCTURE, INC.

1818 MARKET ST. PHILADELPHIA, PA. 19103

Drafted: CRD Checked: ACT Scale: 1" = 400' SHEET

Date: 9/29/97 Approved: ARA 2 of 13

Courtesy airport-hunterdon.org

E:\ACAD\WORK\ISOL\EXISTALP.dwg 21.12.96-14:03 CRD

AIRPORT DATA		
ITEM	EXISTING	PROPOSED
AIRPORT REFERENCE POINT (NAD 83)	40°34'0.97"N 74°44'19"W	40°35'2.80"N 74°44'24.79"W
AIRPORT ELEVATION	195'	195'
MEAN MAX TEMP.	86° F (JULY)	86° F (JULY)
AIRPORT CLASSIFICATION	GENERAL AVIATION	GENERAL AVIATION
AIRPORT ROLE	GENERAL UTILITY (GU)	GENERAL UTILITY (GU)
AIRPORT REFERENCE CODE	B - I (SMALL ONLY)	B - II
AIRPORT ACREAGE	714.04 ac.	762.78 ac.
MAGNETIC VARIATION	11"	11"
TERMINAL NAVAIDS	ROTATING BEACON, VORTAC	ROTATING BEACON, VORTAC
DESIGN AIRCRAFT	CHEYENNE III A	CESSNA 550

LEGEND	
---	PROPERTY LINE
---RSA---	RUNWAY SAFETY AREA
---OFA---	OBJECT FREE AREA
---	RUNWAY PROTECTION ZONE
█	EXISTING BUILDING
█	PROPOSED BUILDING
○	CONTOUR LINE (10')
---	TREE LINE

ITEM	RUNWAY 4-22		RUNWAY 10-28		RUNWAY 13-31		RUNWAY 3-21	
	EXISTING	PROPOSED	EXISTING	PROPOSED	EXISTING	PROPOSED	EXISTING	PROPOSED
RUNWAY DIMENSIONS	3735' x 183' (3000' x 50' PAVED)		2456' x 160'		3440' x 200'	3700' x 75'	4890' x 100'	
TRUE BEARING	N 51°00'00" E		S 6°42'31" E		S 39°00'00" E	S 39°00'00" E	N 51°00'00" E	
EFFECTIVE GRADIENT	0.75%		1.12%		1.10%	0.95%	0.46%	
AW WIND COVERAGE	90.8%		93.0%		92.7%	88.66%	90.7%	
IFR WIND COVERAGE	97.2%		91.3%		89.9%	83.06%	97.14%	
PAVEMENT TYPE	ASPHALT-TURF		TURF		TURF	ASPHALT	ASPHALT	
PAVEMENT STRENGTH	12,500 SW					12,000 SW	30,000 SW	
RUNWAY CATEGORY	NPI-UTILITY		VIS-UTILITY		VIS-UTILITY	NPI-UTILITY	PRECISION	
RUNWAY LIGHTING	MIRL		NONE		NONE	MIRL	HIRL	
RUNWAY MARKING	VISUAL		NONE		NONE	NPI	PIR	
RUNWAY SAFETY AREA	4215' x 120'		2936' x 120'		3750' x 120'	4180' x 150'	6090' x 300'	
RUNWAY PROT. ZONE	500' x 700' x 1,000'		250' x 450' x 1,000'		250' x 450' x 1,000'	500' x 750' x 1,000'	1,000' x 1,750' x 2,500'	500' x 700' x 1,000'
OBJECT FREE AREA	4335' x 250'		3056' x 250'		3800' x 250'	4300' x 500'	6090' x 800'	
	EXISTING		EXISTING		PROPOSED	PROPOSED	PROPOSED	
	RW 4	RW 22	RW 10	RW 28	RW 13	RW 31	RW 3	RW 21
NAVIGATIONAL AIDS	VOR+GPS	VOR+GPS-A	VOR+GPS-A	VOR+GPS-A	VOR+GPS	VOR+GPS	ILS / VOR+GPS	VOR+GPS
VISUAL LIGHTING AIDS	MIRL	MIRL	NONE	NONE	MIRL	PAPI / MIRL	PAPI / HIRL	PAPI / HIRL
APPROACH SLOPE	20:1	20:1	20:1	20:1	20:1	20:1	50:1	34:1
RUNWAY END COORDINATES								
LATITUDE (NAD 83)	40°34'38" N	40°35'2" N	40°35'4" N	40°35'4" N	40° 35' 22.65" N	40° 34' 56.84" N	40° 34' 37.42" N	40° 35' 8.94" N
LONGITUDE (NAD 83)	74°44'37" W	74°44'0" W	74°44'32" W	74°44'32" W	74° 44' 19.64" W	74° 43' 52.75" W	74° 44' 44.2" W	74° 44' 1.61" W
ELEVATION	189.0'	180.2'	187.5'	159'	190'	155'	185'	181'
TAXIWAY WIDTH	25' / 35'							
WEATHER STATION	NEWARK INT'L AIRPORT, NEWARK, NJ							
SOURCE	NATIONAL CLIMATIC DATA CENTER, ASHEVILLE, N.C.							
PERIOD	1981-1990							
TOTAL AW WIND COVERAGE	99.3% / 99.36%							
TOTAL IFR WIND COVERAGE	99.3% / 99.54%							

MODIFICATIONS TO STANDARDS				
ITEM	STANDARD	MODIFICATIONS	REMARKS	APPROVED

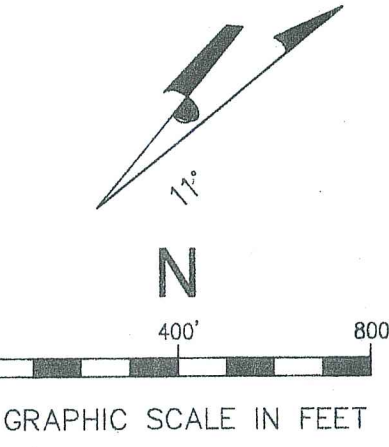

FEDERAL AVIATION ADMINISTRATION

SIGNATURE _____ DATE _____

NJ DEPARTMENT OF TRANSPORTATION

SIGNATURE _____ DATE _____

D&Z TRANSPORTATION SERVICES

SIGNATURE _____ DATE _____

SOLBERG AVIATION COMPANY - SPONSOR

SIGNATURE _____ DATE _____

Unofficial Copy

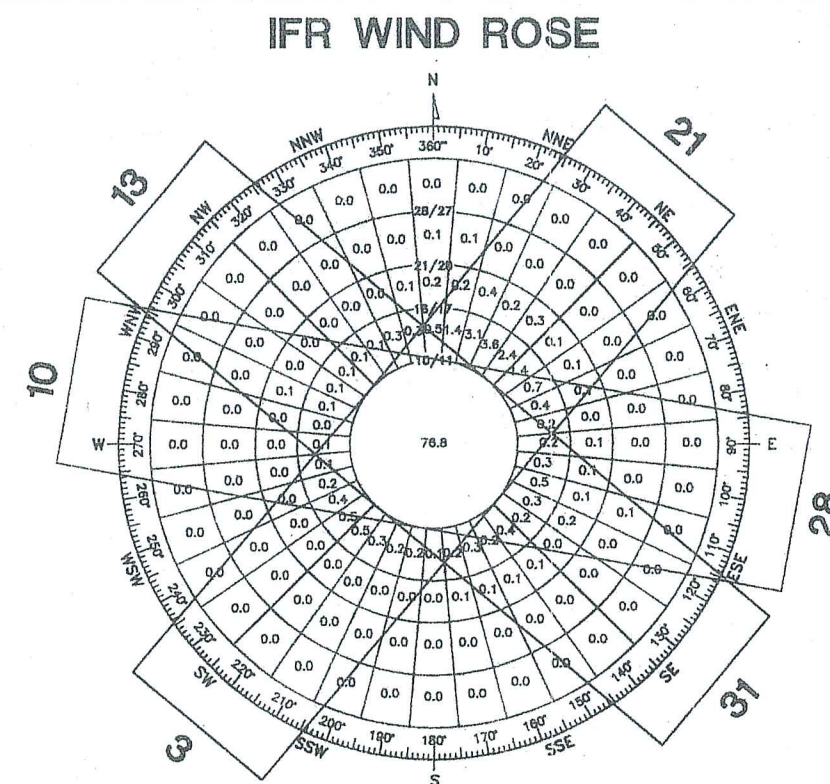
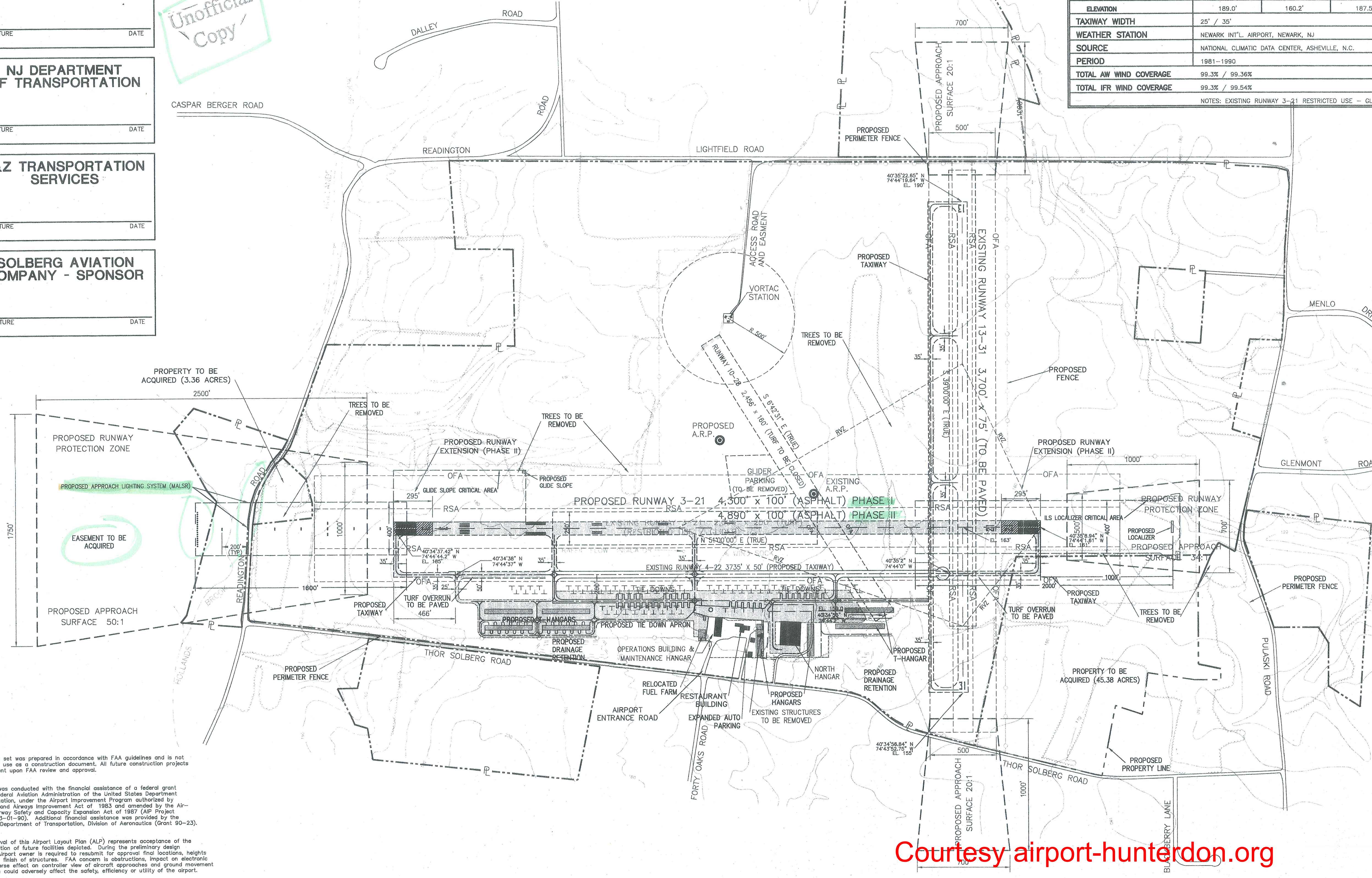

CONDITION	RUNWAY HEADING					
	3	21	10	28	13	31
IFR RW 3-21 13 KNOTS	65.28%	34.23%	CLOSED	CLOSED	47.88%	37.66%
IFR RW 13-31 10.5 KNOTS			97.14%	CLOSED		83.06%
						99.54%

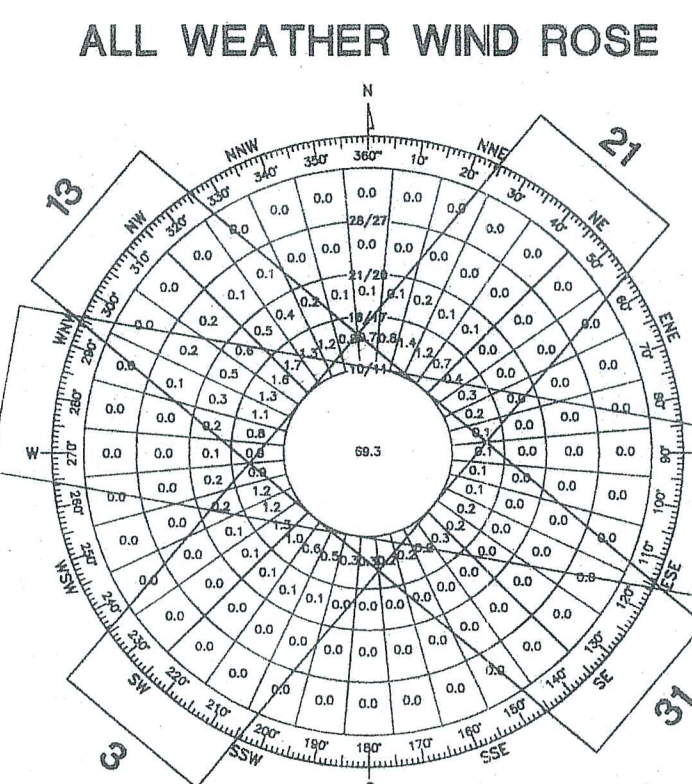

CONDITION	RUNWAY HEADING					
	3	21	10	28	13	31
All Weather RW 3-21 13 KNOTS	39.68%	53.33%	CLOSED	CLOSED	33.76%	35.26%
IFR RW 13-31 10.5 KNOTS			90.7%	CLOSED		88.66%
						99.36%

NO.	REVISION	DATE
Solberg-Hunterdon Airport Readington, NJ		
PROPOSED AIRPORT LAYOUT PLAN		
DAY & ZIMMERMANN INFRASTRUCTURE, INC.		
Drafted: CRD	Checked: ACT	Scale: 1" = 400'
Date: 9/29/97	Approved: ARA	SHEET 3 of 13

Courtesy airport-hunterdon.org

25-09.97-10-13 E:\ACAD\WORK\SOL_PROPALP.dwg

This drawing set was prepared in accordance with FAA guidelines and is not intended for use as a construction document. All future construction projects are contingent upon FAA review and approval.

This study was conducted with the financial assistance of a federal grant from the Federal Aviation Administration of the United States Department of Transportation, under the Airport Improvement Program authorized by the Airport and Airways Improvement Act of 1983 and amended by the Airport and Airways Safety and Capacity Expansion Act of 1987 (AIP Project #3-34-0033-01-90). Additional financial assistance was provided by the New Jersey Department of Transportation, Division of Aeronautics (Grant #9-23).

FAA's approval of this Airport Layout Plan (ALP) represents acceptance of the general location of future facilities depicted. During the preliminary design phase the airport owner is required to resubmit for approval final locations, heights and exterior finish of structures. FAA concern is obstructions, impact on electronic aids or adverse effect on controller view of aircraft approaches and ground movement areas, which could adversely affect the safety, efficiency or utility of the airport.

26.09.97-11:60 E:\ACAD\WORK\SOL\TERMPH1.dwg CRD

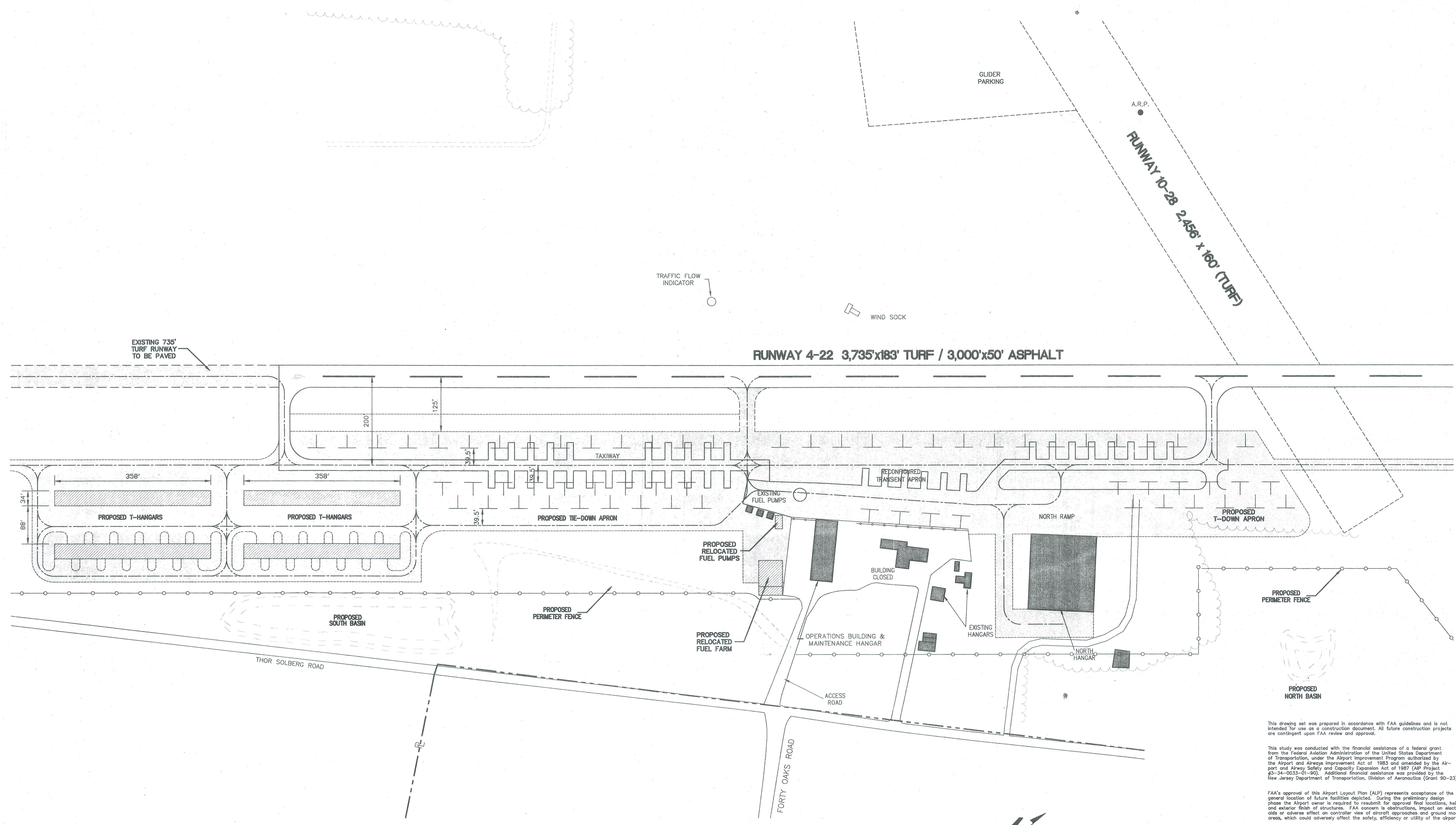

This drawing set was prepared in accordance with FAA guidelines and is not intended for use as a construction document. All future construction projects are contingent upon FAA review and approval.

This study was conducted with the financial assistance of a federal grant from the Federal Aviation Administration of the United States Department of Transportation, under the Airport Improvement Program authorized by the Airport and Airways Improvement Act of 1983 and amended by the Airport and Airways Safety and Capacity Expansion Act of 1987 (AIP Project #3-34-0033-01-90). Additional financial assistance was provided by the New Jersey Department of Transportation, Division of Aeronautics (Grant 90-23).

FAA's approval of this Airport Layout Plan (ALP) represents acceptance of the general location of future facilities depicted. During the preliminary design phase the Airport owner is required to resubmit for approval final locations, heights and exterior finish of structures. FAA concern is obstructions, impact on electronic aids or adverse effect on controller view of aircraft approaches and ground movement areas, which could adversely affect the safety, efficiency or utility of the airport.

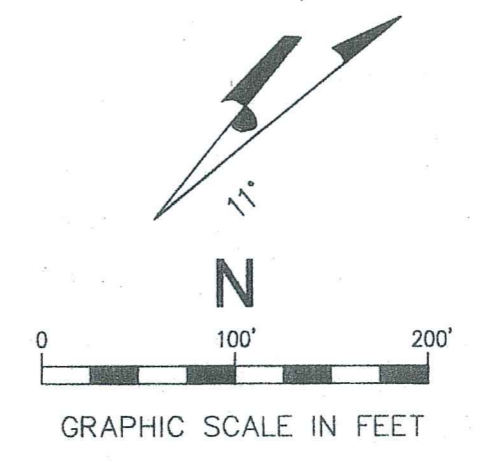

NO.	REVISION	DATE
Solberg-Hunterdon Airport Readington, NJ		
BUILDING AREA PLAN PHASE I		
DAY & ZIMMERMANN INFRASTRUCTURE, INC.		
1818 MARKET ST. PHILADELPHIA, PA. 19103		
Drafted: CRD	Checked: ACT	Scale: 1" = 100'
Date: 9/29/97	Approved: ARA	
		SHEET 4 of 13

Courtesy airport-hunterdon.org

26.09.97-13:18 E:\ACAD\WORK\ISOL\TERMPH2.dwg CRD

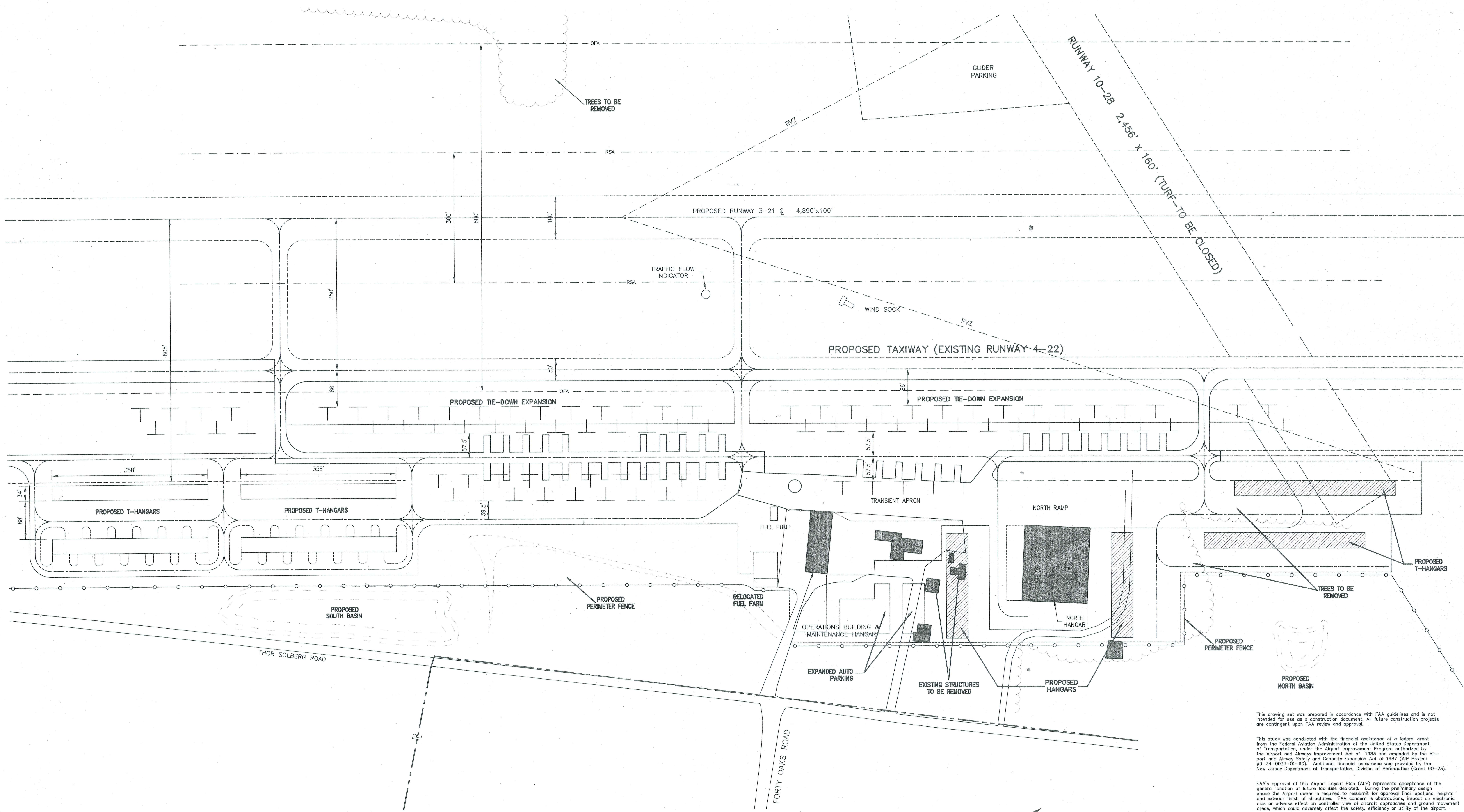

This drawing set was prepared in accordance with FAA guidelines and is not intended for use as a construction document. All future construction projects are contingent upon FAA review and approval.

This study was conducted with the financial assistance of a federal grant from the Federal Aviation Administration of the United States Department of Transportation, under the Airport Improvement Program authorized by the Airport and Airways Improvement Act of 1983 and amended by the Airport and Airways Safety and Capacity Expansion Act of 1987 (AIP Project #3-34-0033-01-90). Additional financial assistance was provided by the New Jersey Department of Transportation, Division of Aeronautics (Grant 90-23).

FAA's approval of this Airport Layout Plan (ALP) represents acceptance of the general location of future facilities depicted. During the preliminary design phase the Airport owner is required to resubmit for approval final locations, heights and exterior finish of structures. FAA concern is obstructions, impact on electronic aids or adverse effect on controller view of aircraft approaches and ground movement areas, which could adversely affect the safety, efficiency or utility of the airport.

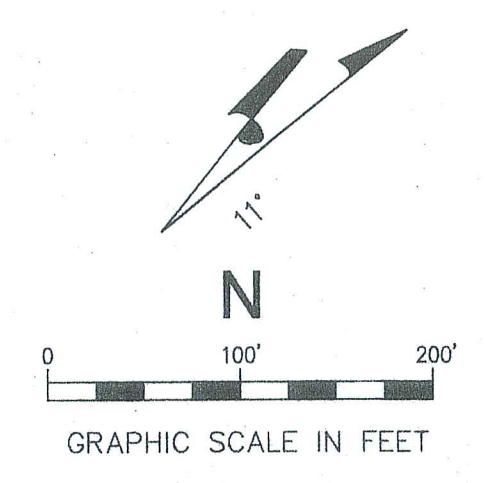

NO.	REVISION	DATE
Solberg-Hunterdon Airport		Readington, NJ
BUILDING AREA PLAN PHASE II		
DAY & ZIMMERMANN INFRASTRUCTURE, INC.		
<small>1816 MARKET ST. PHILADELPHIA, PA. 19103</small>		
Drafted: CRD	Checked: ACT	Scale: 1" = 100'
Date: 9/29/97	Approved: ARA	SHEET 5 of 13

Courtesy airport-hunterdon.org

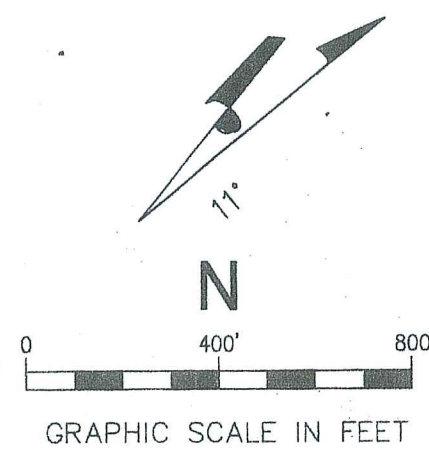
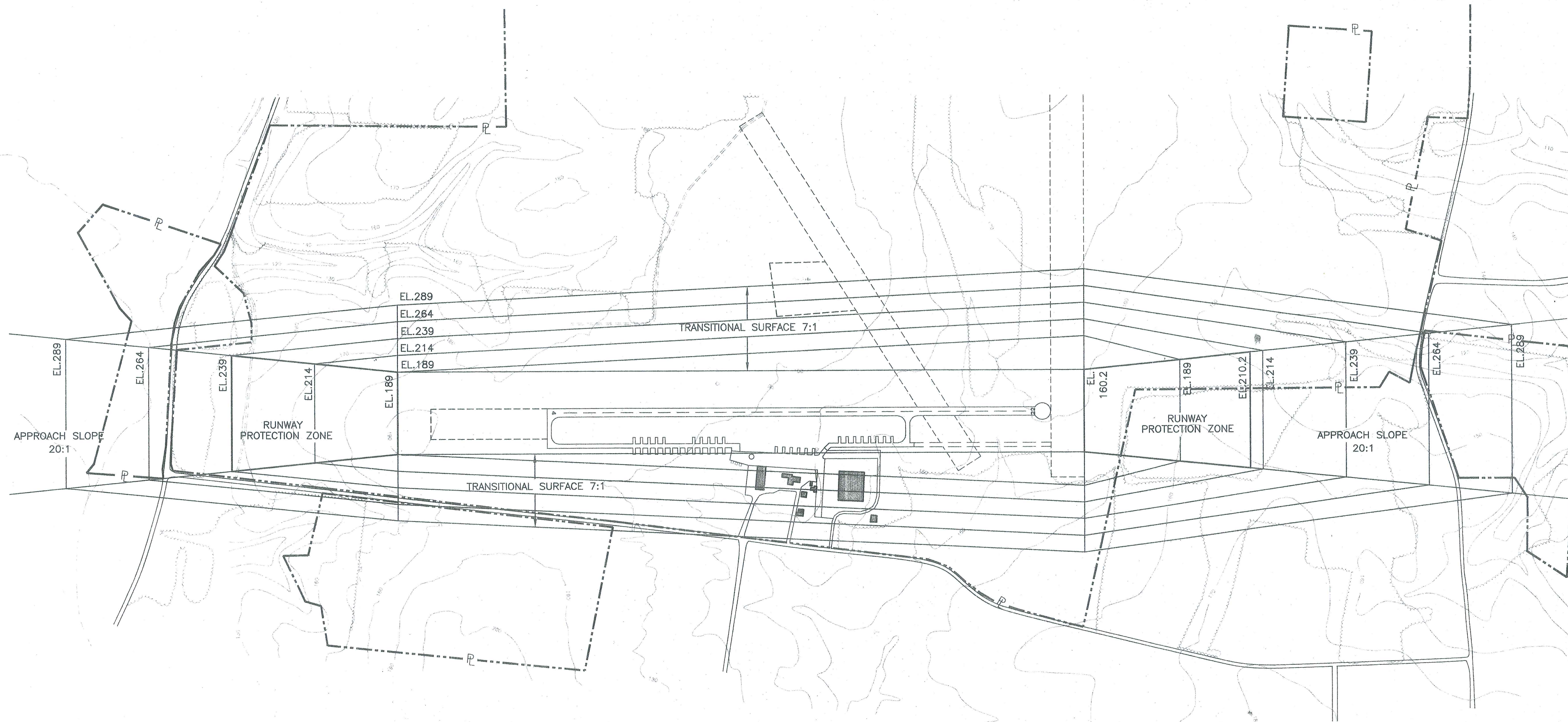

EXISTING RUNWAY 4-22 APPROACH PLAN

SCALE: 1"=400'

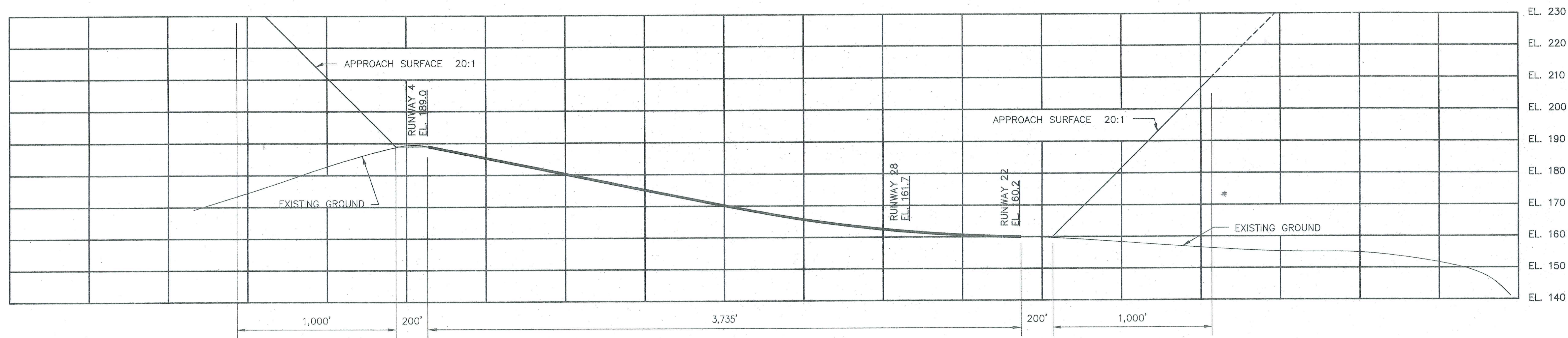

EXISTING RUNWAY 4-22 CENTERLINE PROFILE

SCALE: VERT. 1"=20'
HORIZ. 1"=400'

This drawing set was prepared in accordance with FAA guidelines and is not intended for use as a construction document. All future construction projects are contingent upon FAA review and approval.

This study was conducted with the financial assistance of a federal grant from the Federal Aviation Administration of the United States Department of Transportation, under the Airport Improvement Program authorized by the Airport and Airway Improvement Act of 1983 and amended by the Airport and Airway Safety and Capacity Expansion Act of 1987 (AP Project #3-34-0033-01-90). Additional financial assistance was provided by the New Jersey Department of Transportation, Division of Aeronautics (Grant 90-23).

FAA's approval of this Airport Layout Plan (ALP) represents acceptance of the general location of future facilities depicted. During the preliminary design phase the Airport owner is required to resubmit for approval final locations, heights and exterior finish of structures. FAA concern is obstructions, impact on electronic aids or adverse effect on controller view of aircraft approaches and ground movement areas, which could adversely affect the safety, efficiency or utility of the airport.

NO.	REVISION	DATE
Solberg-Hunterdon Airport Readington, NJ		
EXISTING RUNWAY 4-22 APPROACH PLAN AND CENTERLINE PROFILE		
DAY & ZIMMERMANN INFRASTRUCTURE, INC.		
<small>1818 MARKET ST. PHILADELPHIA, PA. 19103</small>		
Drafted: CRD	Checked: ACT	Scale: As Noted
Date: 9/29/97	Approved: ARA	SHEET 6 of 13

Courtesy airport-hunterdon.org

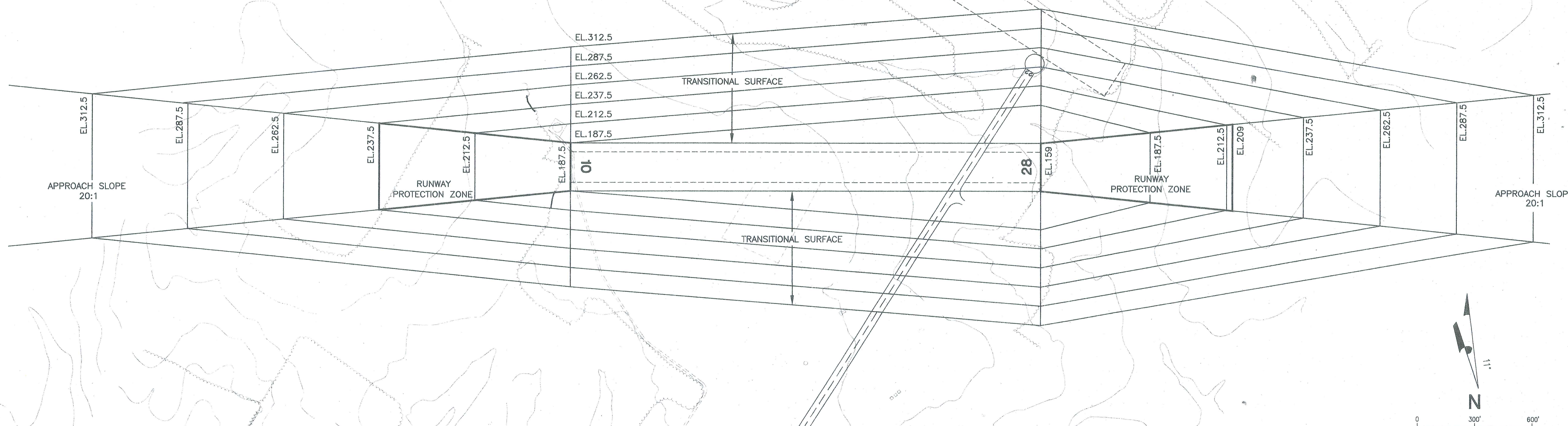

EXISTING RUNWAY 10-28 APPROACH PLAN

SCALE: 1"=300'

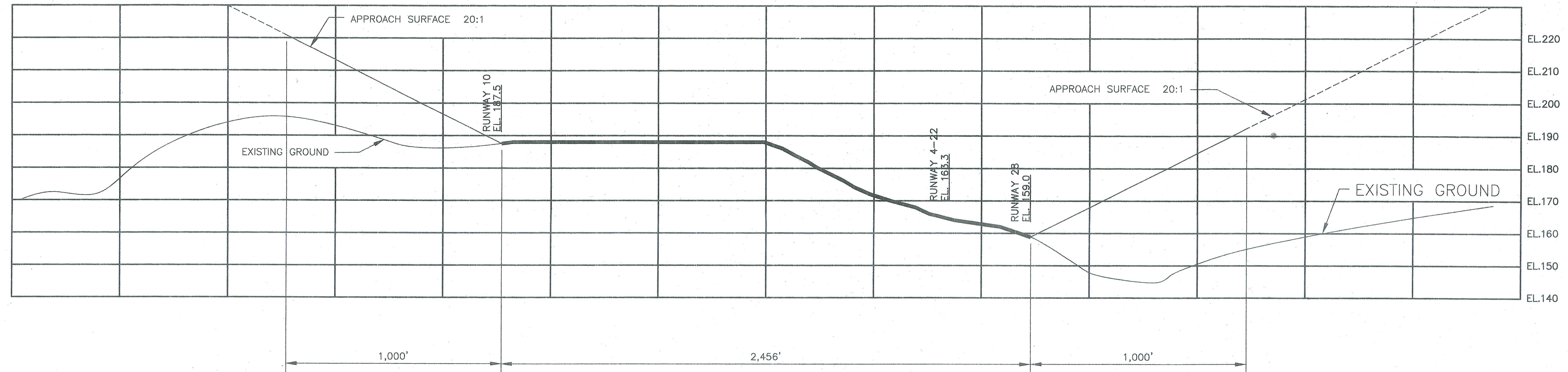

EXISTING RUNWAY 10-28 CENTERLINE PROFILE

SCALE: VERT. 1"=20'
HORIZ. 1"=300'

This drawing set was prepared in accordance with FAA guidelines and is not intended for use as a construction document. All future construction projects are contingent upon FAA review and approval.

This study was conducted with the financial assistance of a federal grant from the Federal Aviation Administration of the United States Department of Transportation, under the Airport Improvement Program authorized by the Airport and Airway Improvement Act of 1983 and amended by the Airport and Airway Safety and Capacity Expansion Act of 1987 (AIR Project #3-34-0033-01-90). Additional financial assistance was provided by the New Jersey Department of Transportation, Division of Aeronautics (Grant 90-23).

FAA's approval of this Airport Layout Plan (ALP) represents acceptance of the general location of future facilities depicted. During the preliminary design phase the Airport owner is required to resubmit for approval final locations, heights and exterior finish of structures. FAA concern is obstructions, impact on electronic aids or adverse effect on controller view of aircraft approaches and ground movement areas, which could adversely affect the safety, efficiency or utility of the airport.

NO.	REVISION	DATE
Solberg-Hunterdon Airport Readington, NJ		
EXISTING RUNWAY 10-28 APPROACH PLAN AND CENTERLINE PROFILE		
DAY & ZIMMERMANN INFRASTRUCTURE, INC.		
<small>1818 MARKET ST. PHILADELPHIA, PA. 19103</small>		
Drafted: CRD	Checked: ACT	Scale: 1" = 300'
Date: 9/29/97	Approved: ARA	SHEET 7 of 13

Courtesy airport-hunterdon.org

26.09.97-13:51 E:\ACAD\WORK\SOL\APT10-28.dwg CRD

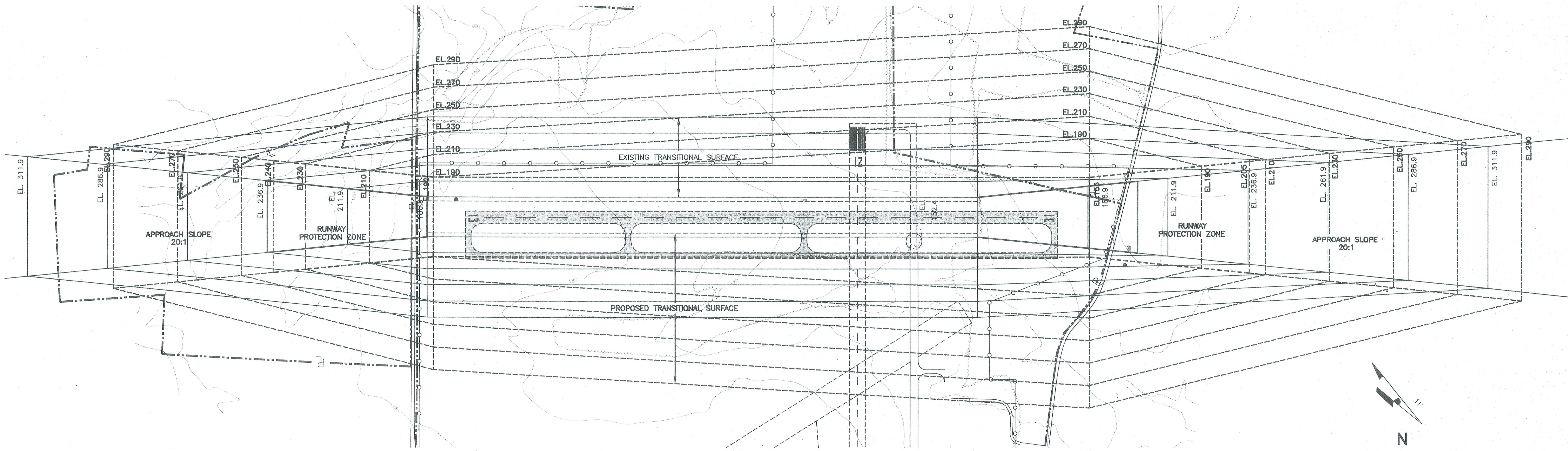

EXISTING AND PROPOSED RUNWAY 13-31 APPROACH PLAN

SCALE: 1"=300'

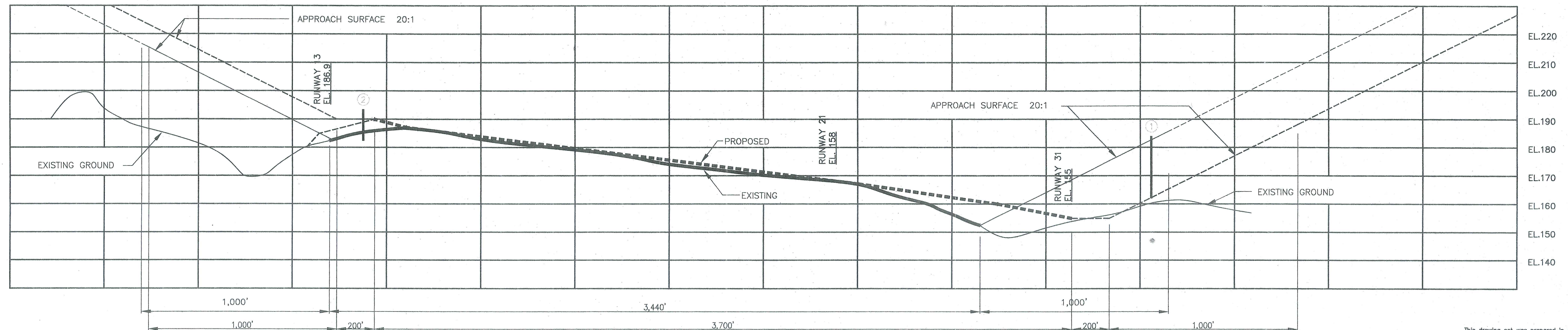

EXISTING AND PROPOSED RUNWAY 13-31 CENTERLINE PROFILE

SCALE: VERT. 1"=20'
HORIZ. 1"=300'

LEGEND
EXISTING SURFACE ———
PROPOSED SURFACE - - - - -

OBSTRUCTION CHART				
NO.	DESCRIPTION	ELEVATION	OBSTRUCTION	RECOMMENDATION
1	TREES	44'	OBSTRUCTION	REMOVE
2	TREES	24'	OBSTRUCTION	REMOVE

This drawing set was prepared in accordance with FAA guidelines and is not intended for use as a construction document. All future construction projects are contingent upon FAA review and approval.

This study was conducted with the financial assistance of a federal grant from the Federal Aviation Administration of the United States Department of Transportation, under the Airport Improvement Program authorized by the Airport and Airway Improvement Act of 1983 and amended by the Airport and Airway Safety and Capacity Expansion Act of 1987 (AP Project #3-34-0033-01-90). Additional financial assistance was provided by the New Jersey Department of Transportation, Division of Aeronautics (Grant 90-23).

FAA's approval of this Airport Layout Plan (ALP) represents acceptance of the general location of future facilities depicted. During the preliminary design phase the Airport owner is required to resubmit for approval final locations, heights and exterior finish of structures. FAA concern is obstructions, impact on electronic aids or adverse effect on controller view of aircraft approaches and ground movement areas, which could adversely affect the safety, efficiency or utility of the airport.

NO.	REVISION	DATE
Solberg-Hunterdon Airport Readington, NJ		
EXISTING AND PROPOSED RUNWAY 13-31 APPROACH PLAN AND CENTERLINE PROFILE		
DAY & ZIMMERMANN INFRASTRUCTURE, INC. 1818 MARKET ST. PHILADELPHIA, PA. 19103		
Drafted: CRD	Checked: ACT	SHEET
Date: 9/29/97	Approved: ARA	Scale: As Noted 8 of 13

Courtesy airport-hunterdon.org

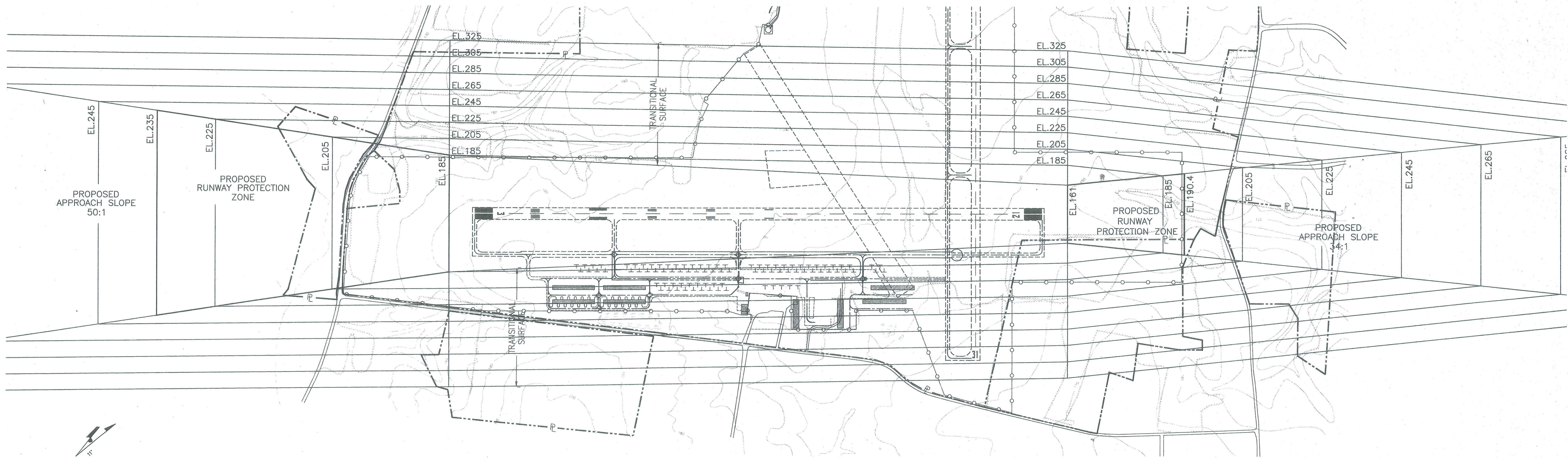

PROPOSED RUNWAY 3-21 APPROACH PLAN

SCALE: 1"=400'

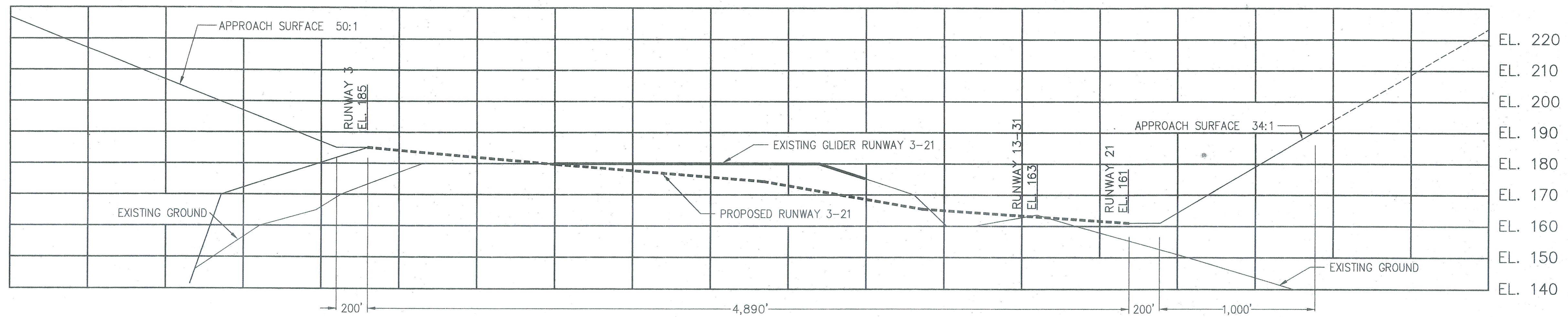
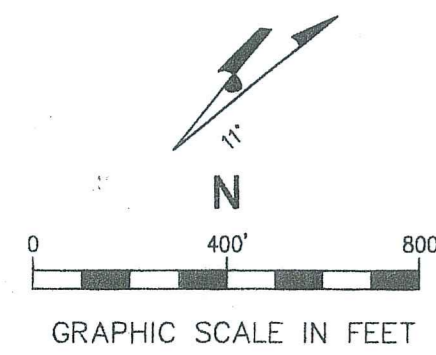

PROPOSED RUNWAY 3-21 CENTERLINE PROFILE

SCALE: VERT. 1"=20'
HORIZ. 1"=400'

This drawing set was prepared in accordance with FAA guidelines and is not intended for use as a construction document. All future construction projects are contingent upon FAA review and approval.

This study was conducted with the financial assistance of a federal grant from the Federal Aviation Administration of the United States Department of Transportation, under the Airport Improvement Program authorized by the Airport and Airway Improvement Act of 1985 and amended by the Airport and Airway Safety and Capacity Expansion Act of 1987 (AP Project #3-34-033-01-80). Additional financial assistance was provided by the New Jersey Department of Transportation, Office of Aviation (Grant 90-23).

FAA's approval of this Airport Layout Plan (ALP) represents acceptance of the general location of future facilities depicted. During the preliminary design phase the Airport owner is required to resubmit for approval final locations, heights and exterior finish of structures. FAA concerns its construction, impact on electronic aids or adverse effect on controller view of aircraft approaches and ground movement areas, which could adversely affect the safety, efficiency or utility of the airport.

26.09.97-07:59 EX:ACAD\WORK\SOL\AF3-21.dwg CRD

NO.	REVISION	DATE
Solberg-Hunterdon Airport Readington, NJ		
PROPOSED RUNWAY 3-21 APPROACH PLAN AND CENTERLINE PROFILE		
DAY & ZIMMERMANN INFRASTRUCTURE, INC.		
<small>1818 MARKET ST. PHILADELPHIA, PA. 19103</small>		
Drafted: CRD	Checked: ACT	Scale: As Noted
Date: 9/29/97	Approved: ARA	SHEET 9 of 13

Courtesy airport-hunterdon.org

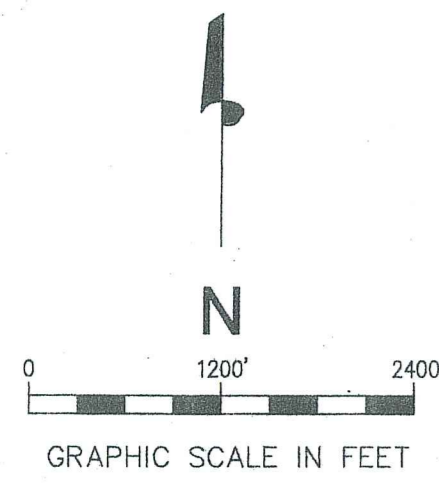

D:\APPS\ACAD\WORK\SOL\PART-77

22.12.96-11:29

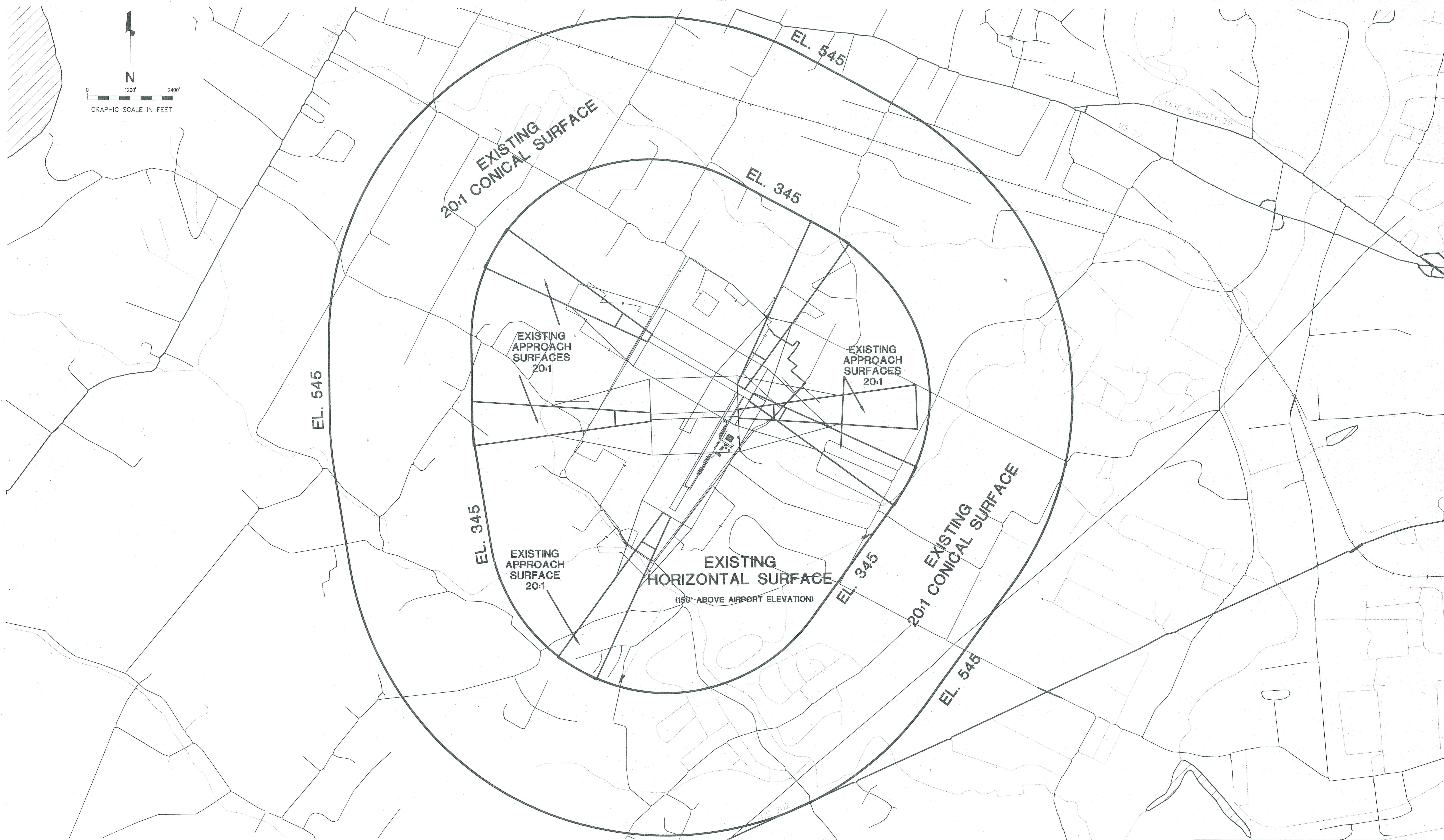

This drawing set was prepared in accordance with FAA guidelines and is not intended for use as a construction document. All future construction projects are contingent upon FAA review and approval.

This study was conducted with the financial assistance of a federal grant from the Federal Aviation Administration of the United States Department of Transportation, under the Airport Improvement Program authorized by the Airport and Airways Improvement Act of 1983 and amended by the Airport and Airways Safety and Capacity Expansion Act of 1987 (AIP Project #3-34-0033-01-90). Additional financial assistance was provided by the New Jersey Department of Transportation, Division of Aeronautics (Grant 90-23).

FAA's approval of this Airport Layout Plan (ALP) represents acceptance of the general location of future facilities depicted. During the preliminary design phase the Airport owner is required to resubmit for approval final locations, heights and exterior finish of structures. FAA concern is obstructions, impact on electronic aids or adverse effect on controller view of aircraft approaches and ground movement areas, which could adversely affect the safety, efficiency or utility of the airport.

NO.	REVISION	DATE
	Solberg-Hunterdon Airport	Readington, NJ
EXISTING AIRPORT SURFACES PART 77		
DAY & ZIMMERMANN INFRASTRUCTURE, INC.		
Drafted: CRD	Checked: ACT	Scale: 1" = 1200'
Date: 9/29/97	Approved: ARA	SHEET 10 of 13

Courtesy airport-hunterdon.org

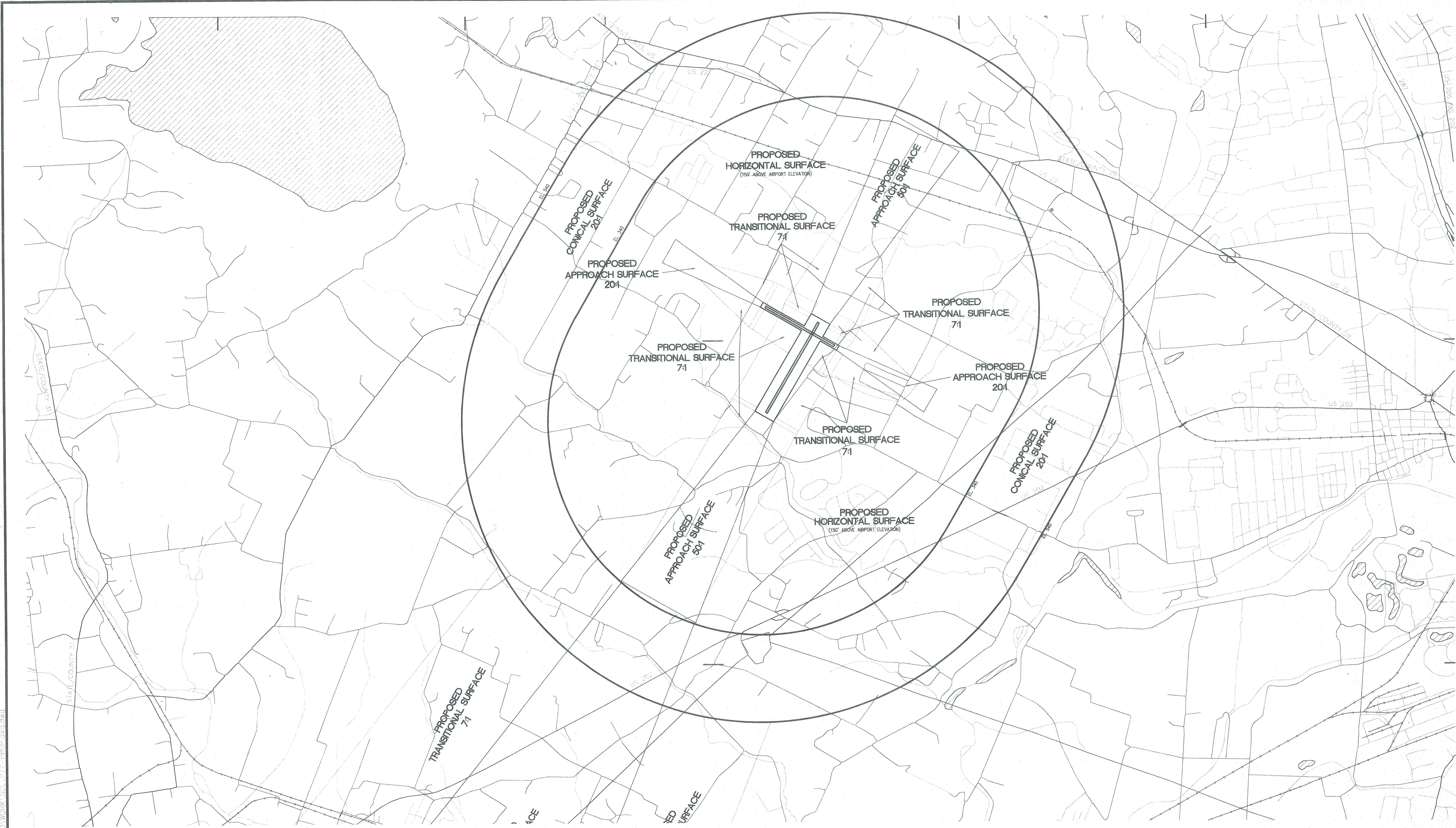

This drawing set was prepared in accordance with FAA guidelines and is not intended for use as a construction document. All future construction projects are contingent upon FAA review and approval.

This study was conducted with the financial assistance of a federal grant from the Federal Aviation Administration of the United States Department of Transportation, under the Airport Improvement Program authorized by the Airport and Airways Improvement Act of 1983 and amended by the Airport and Airways Safety and Capacity Expansion Act of 1987 (AIP Project #3-94-0033-01-90). Additional financial assistance was provided by the New Jersey Department of Transportation, Division of Aeronautics (Grant 90-23).

FAA's approval of this Airport Layout Plan (ALP) represents acceptance of the general location of future facilities depicted. During the preliminary design phase the Airport owner is required to resubmit for approval final locations, heights and exterior finish of structures. FAA concern is obstructions, impact on electronic aids or adverse effect on controller view of aircraft approaches and ground movement areas, which could adversely affect the safety, efficiency or utility of the airport.

NO.	REVISION	DATE
Solberg-Hunterdon Airport		Readington, NJ
PROPOSED AIRPORT SURFACES PART 77		
DAY & ZIMMERMANN INFRASTRUCTURE, INC.		
<small>1818 MARKET ST. PHILADELPHIA, PA. 19103</small>		
Drafted: CRD	Checked: ACT	Scale: 1" = 2000'
Date: 9/29/97	Approved: ARA	SHEET 11 of 13

Courtesy airport-hunterdon.org

20.05.97 10:44 E:\ACAD\WORK\SOL\1077-PROP.dwg.dwg

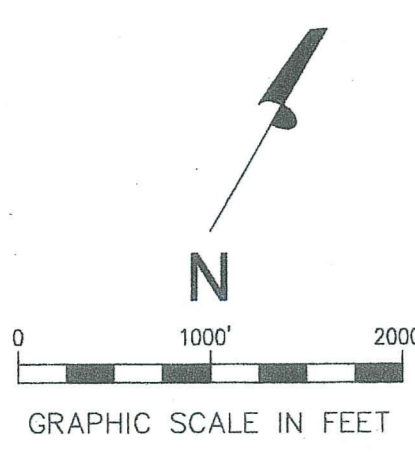
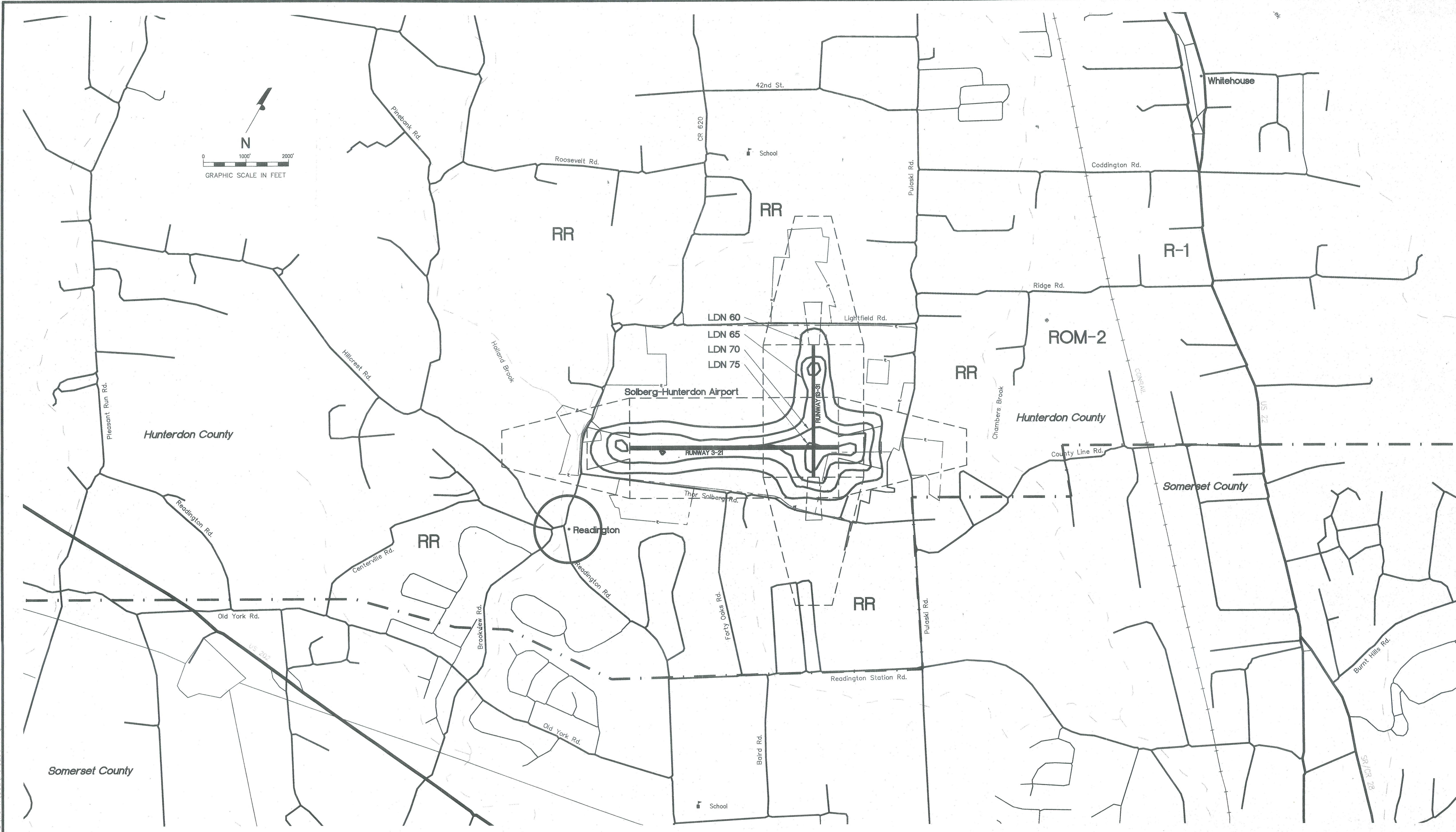

This drawing set was prepared in accordance with FAA guidelines and is not intended for use as a construction document. All future construction projects are contingent upon FAA review and approval.

This study was conducted with the financial assistance of a federal grant from the Federal Aviation Administration of the United States Department of Transportation, under the Airport Improvement Program authorized by the Airport and Airway Safety and Capacity Expansion Act of 1987 (AIP Project #3-34-033-01-90). Additional financial assistance was provided by the New Jersey Department of Transportation, Division of Aeronautics (Grant 90-23).

FAA's approval of this Airport Layout Plan (ALP) represents acceptance of the general location of future facilities depicted. During the preliminary design phase the Airport owner is required to resubmit for approval final locations, heights and exterior finish of structures. FAA concern is obstructions, impact on electronic aids or adverse effect on controller's view of aircraft approaches and ground movement areas, which could adversely affect the safety, efficiency or utility of the airport.

- ZONING LEGEND**
- ROM-2 RESEARCH - OFFICE - MANUFACTURING
 - R-1 RESIDENTIAL
 - RR RURAL RESIDENTIAL
 - HAMLET

NOTE: 60 LDN CONTOUR DOES NOT EXTEND BEYOND EXISTING AIRPORT PROPERTY OR THE PROPERTY PROPOSED FOR ACQUISITION BY THE SPONSOR.

Courtesy airport-hunterdon.org

NO.	REVISION	DATE
	Solberg-Hunterdon Airport	Readington, NJ
2015 NOISE CONTOURS AND N.J. AIR SAFETY ZONE		
DAY & ZIMMERMANN INFRASTRUCTURE, INC.		
Drafted: CRD	Checked: ACT	Scale: 1" = 1000'
Date: 9/29/97	Approved: ARA	12 of 13

27.02.97-16:56 E:\ACAD\WORK\ISOL\NOISECON.dwg

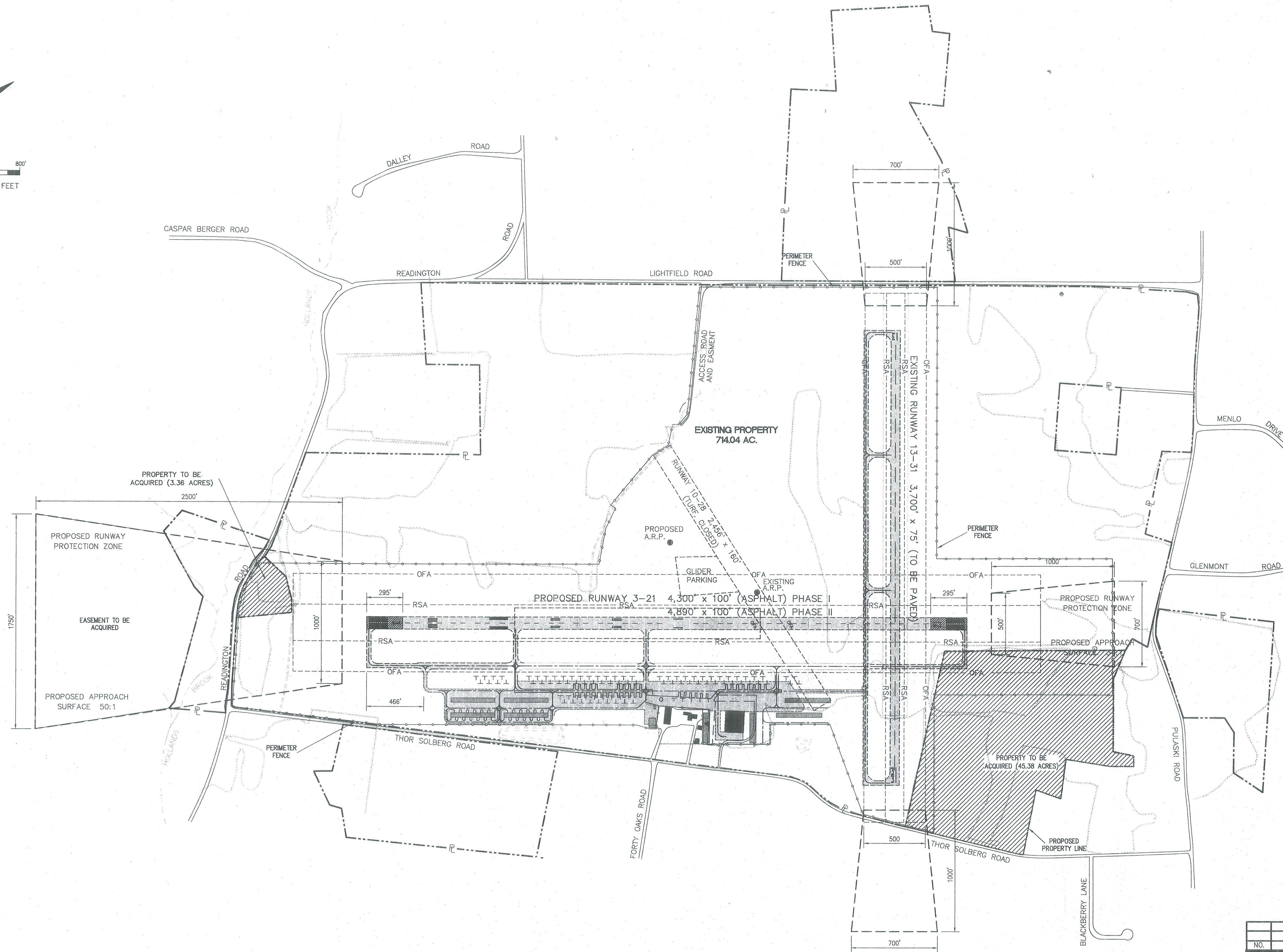
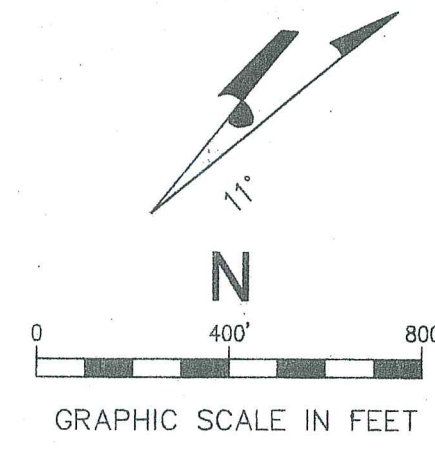

This drawing set was prepared in accordance with FAA guidelines and is not intended for use as a construction document. All future construction projects are contingent upon FAA review and approval.

This study was conducted with the financial assistance of a federal grant from the Federal Aviation Administration of the United States Department of Transportation, under the Airport Improvement Program authorized by the Airport and Airways Improvement Act of 1983 and amended by the Airport and Airways Safety and Capacity Expansion Act of 1987 (AIP Project #3-34-0033-01-80). Additional financial assistance was provided by the New Jersey Department of Transportation, Division of Aeronautics (Grant 90-23).

FAA's approval of this Airport Layout Plan (ALP) represents acceptance of the general location of future facilities depicted. During the preliminary design phase the Airport owner is required to resubmit for approval final locations, heights and exterior finish of structures. FAA concern is obstructions, impact on electronic aids or adverse effect on controller view of aircraft approaches and ground movement areas, which could adversely affect the safety, efficiency or utility of the airport.

NO.	REVISION	DATE
Solberg-Hunterdon Airport		Readington, NJ
EXHIBIT 'A' PROPERTY MAP		
DAY & ZIMMERMANN INFRASTRUCTURE, INC.		
<small>1818 MARKET ST. PHILADELPHIA, PA. 19103</small>		
Drawn: CRD	Checked: ACT	Scale: 1" = 400'
Date: 9/29/97	Approved: ARA	SHEET 13 of 13

Courtesy airport-hunterdon.org